



London, SE27 0AN

**Asking Price £535,000**

Galloways are delighted to present to the market this beautifully presented three-bedroom first-floor apartment set within an attractive Victorian Mansion block.

Spanning an impressive 932 sq ft, this spacious and well-maintained home offers an abundance of natural light and well-proportioned rooms throughout. The property features three generous double bedrooms, a bright and airy reception room with direct access to a private balcony, a separate fitted kitchen, and access to a communal garden.

Well-presented throughout, the property offers a neutral, blank canvas ideal for buyers looking to move straight in, while also having the potential to make it their own.

Ideally located in the heart of West Norwood, residents will enjoy a wide range of excellent amenities on their doorstep, including independent cafes, restaurants, shops, and leisure facilities.

The property is superbly positioned for transport, with both Tulse Hill Station (approximately a 6-minute walk – 0.2 miles) and West Norwood Station (approximately a 9-minute walk – 0.4 miles) within easy reach. These stations offer convenient access to London Bridge, London Blackfriars, Farringdon, and London Victoria, making it an excellent choice for commuters.

Additionally, the property is within easy reach of a variety of green open spaces, including the much-loved Brockwell Park.

- VICTORIAN MANSION BLOCK
- THREE DOUBLE BEDROOMS
- TOTAL AREA SPACE 932 SQ FT / 86.6 SQ M
- MODERN KITCHEN/BREAKFAST ROOM
- COMMUNAL COURTYARD GARDEN
- BALCONY
- 6 MINUTES WALK TO TULSE HILL TRAIN STATION
- 9 MINUTES WALK TO WEST NORWOOD TRAIN STATION
- (WALKING TIMES ESTIMATED BY GOOGLE MAPS)

**Viewing**

Please contact our Galloways West Norwood Office on 020 8766 6111

if you wish to arrange a viewing appointment for this property or

require further information



## Floor Plan

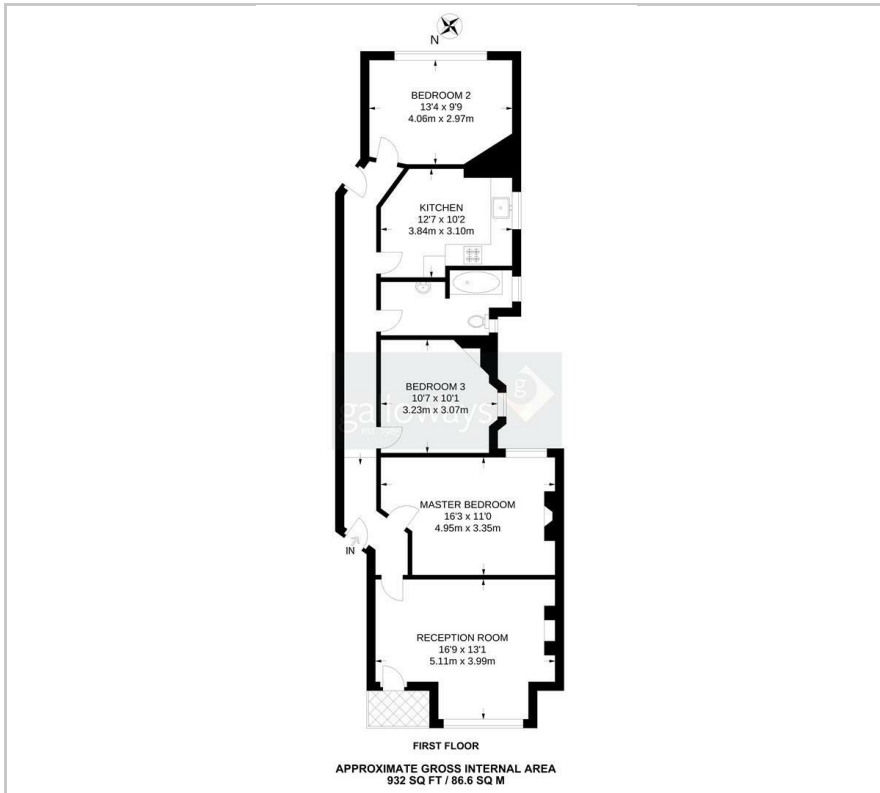

## Area Map



## Energy Efficiency Graph

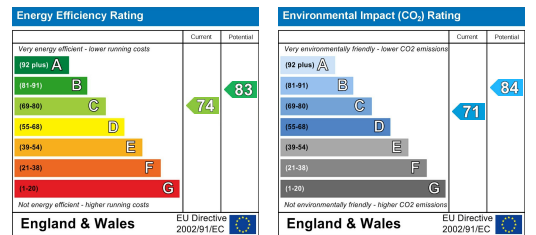

These particulars, whilst believed to be accurate are set out as a general outline only for guidance and do not constitute any part of an offer or contract. Intending purchasers should not rely on them as statements of representation of fact, but must satisfy themselves by inspection or otherwise as to their accuracy. No person in this firm's employment has the authority to make or give any representation or warranty in respect of the property.